



TK International
020 7794 8700
www.t-k.co.uk

Residential Sales
Residential Lettings
Property Management

Sales Office:
9 Heath Street
Hampstead
London NW3 6TP
E: sales@t-k.co.uk

Lettings Office:
16-18 Heath Street
Hampstead
London NW3 6TE
E: lettings@t-k.co.uk

tk.international
TK International
TK International

Est.
1998



Greenaway Gardens London NW3

Situated on the first floor of an attractive block on one of Hampstead's premier roads, a bright and immaculately presented three double bedroom lateral apartment, with the benefit of a private balcony and designated off street parking.

This spacious and modern apartment comprises an impressive 22'4 reception room with floor to ceiling bay windows and the beautifully appointed Boffi kitchen benefits from Miele & Gaggenau appliances. Further benefits include electric underfloor heating in both the kitchen and bathrooms.

Greenaway Gardens is a stunning tree-lined avenue boasting Ambassadorial style residences and is widely considered to be one of the best addresses in Hampstead. It is also conveniently situated for the amenities and transport links of both Hampstead Village (Northern Line) and Finchley Road (Jubilee & Metropolitan Lines), in addition to the open spaces of Hampstead Heath.

EPC Rating: C

£5,500 Per Month

SOLE AGENT





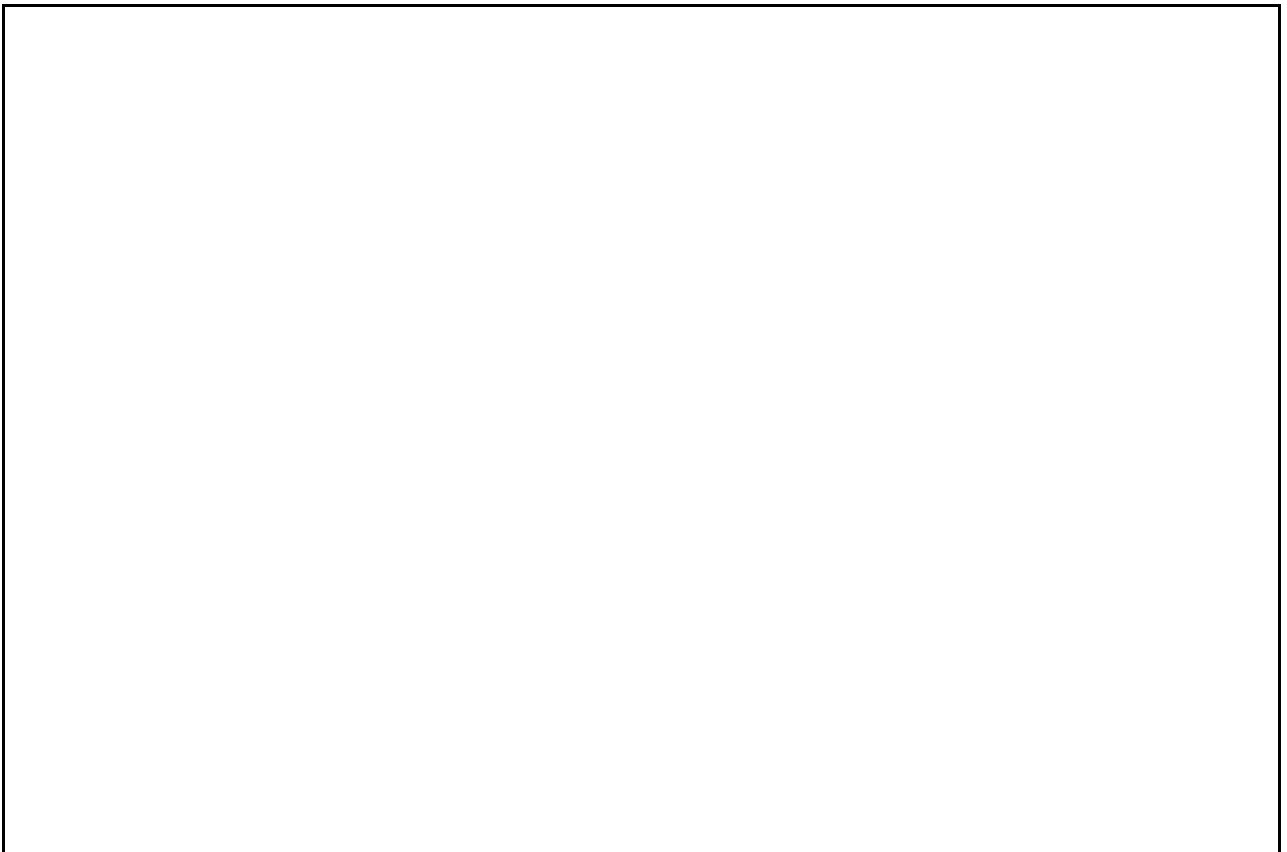

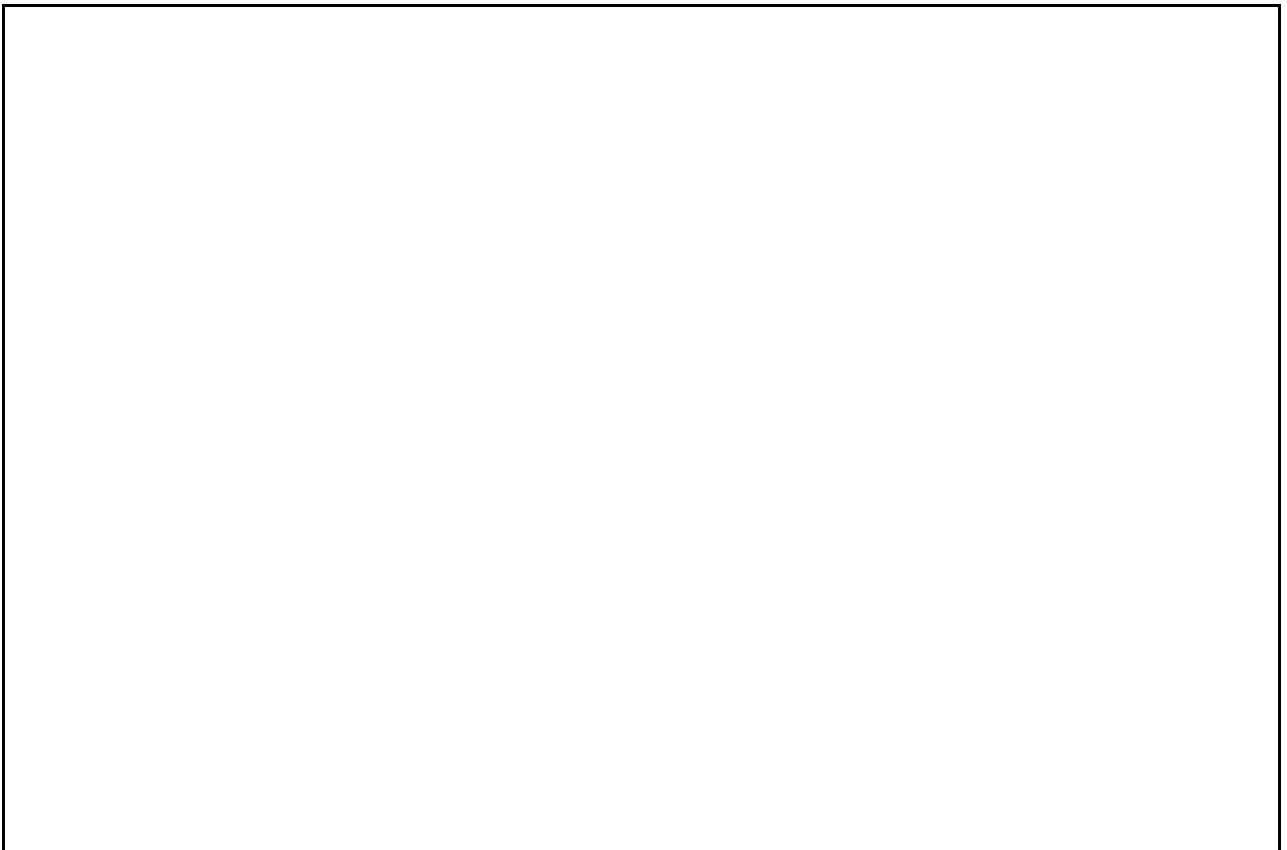
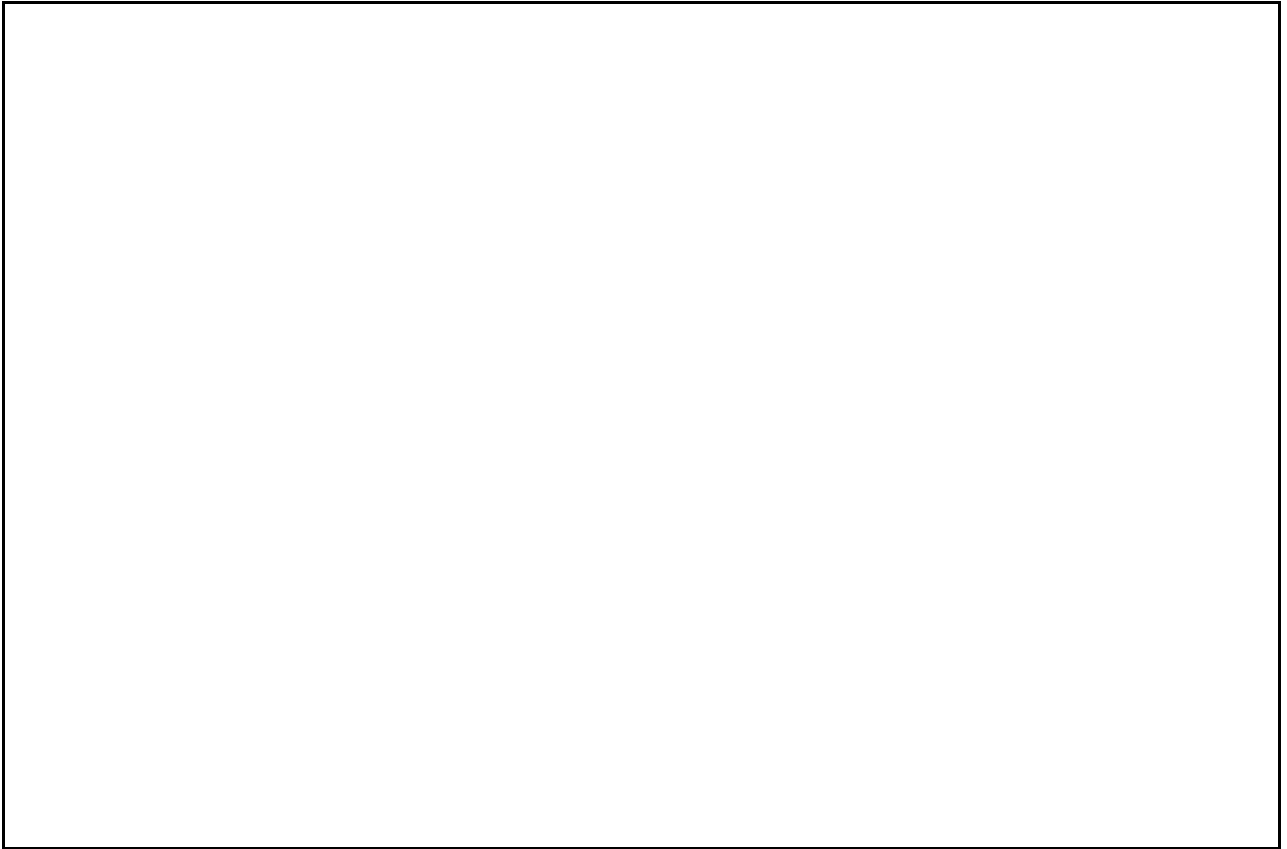

**Greenaway Gardens,
Hampstead, NW3**

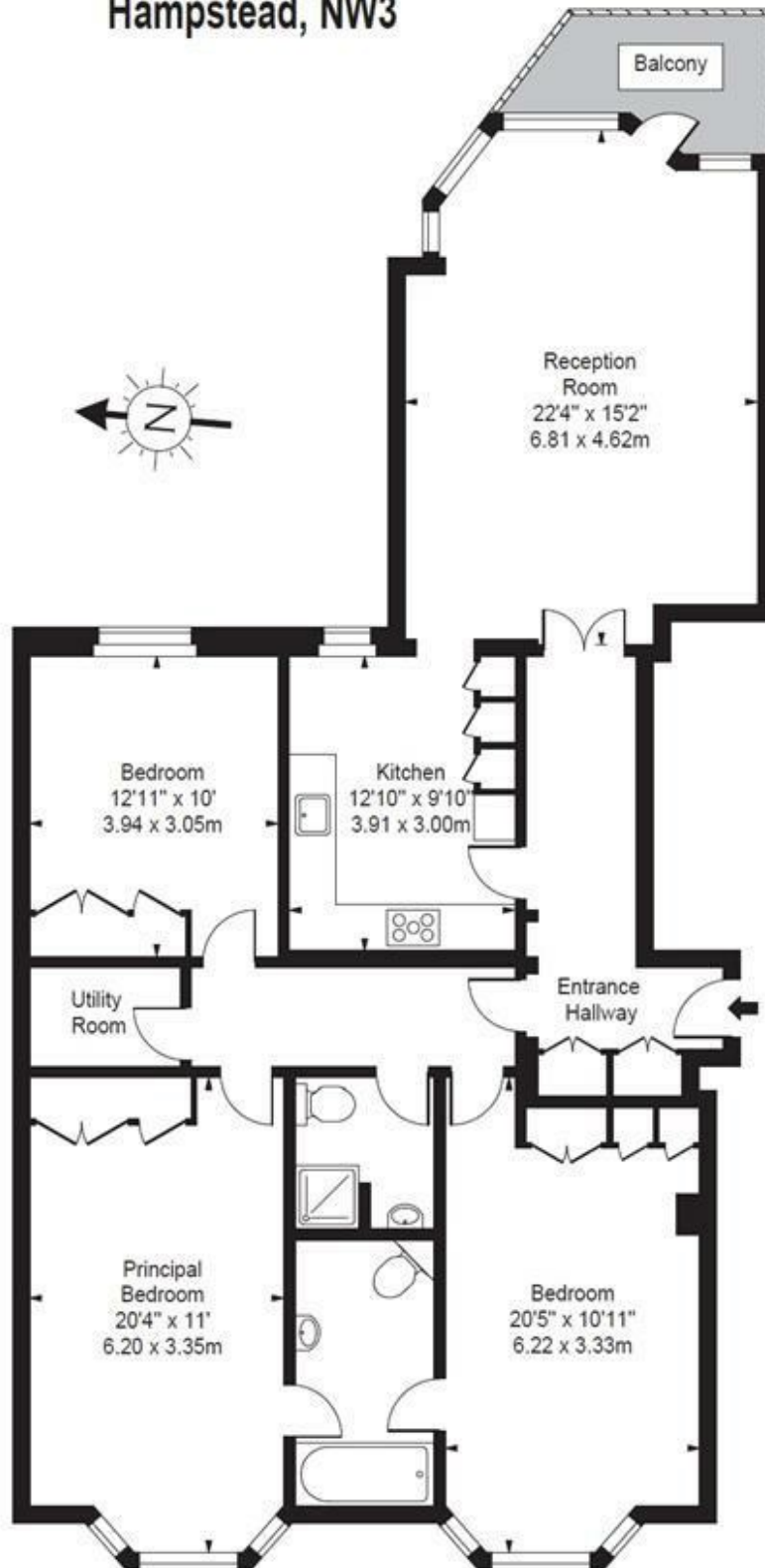

First Floor

Approx Gross Internal Area 1391 Sq Ft - 129.22 Sq M

For Illustration Purposes Only - Not To Scale Floor Plan by www.nogaphotostudio.com Ref: No.36890

This floor plan should be used as a general outline for guidance only. Any intending purchaser or lessee should satisfy themselves by inspection, searches, enquiries and full survey as to the correctness of each statement. Any areas, measurements or distances quoted are approximate and should not be used to value a property or be the basis of any sale or let.